



# TECAPRES®

Ø38,2mm  
300daN

# TPHC 300

VDI SAFETY



PED  
2014/68/EU

MICRO

TITAN

TPH

TPS

TPSP

TPF

TPK

TPC

TPR

TPB

TPHC

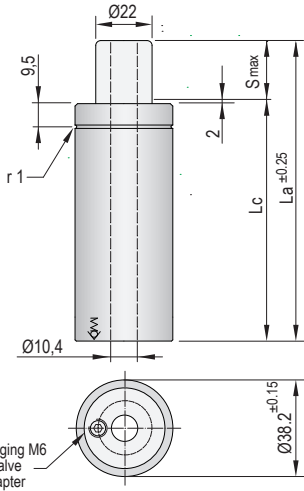

- Pressure medium **Nitrogen (N<sub>2</sub>)**
- Max. charging pressure **150 Bar**
- Min. charging pressure **35 Bar**
- Rod seal area **2,04 cm<sup>2</sup>**
- Operating temperature **0°C - 80°C**
- Force increase by temperature **0,33 %/°C**
- Max. stem speed **0,5 m/s**
- Maintenance kit **Kit HC300**

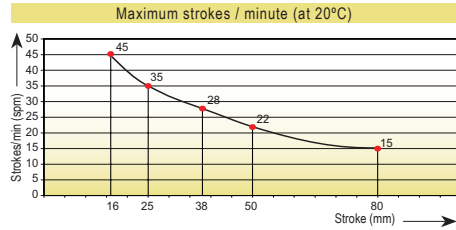

Code	Smax mm	La mm	Lc mm		Fa daN		F daN		Fc daN		P Bar	V l		Kg	
TPHC300X16	16	108	92	300 ±5% (20°C)	345		345		350		150 (20°C)	0,025		0,35	
TPHC300X25	25	126	101				355		365					0,031	0,40
TPHC300X38	38	152	114				370		380					0,040	0,51
TPHC300X50	50	176	126				380		390					0,047	0,58
TPHC300X80	80	236	156				390		405					0,066	0,71

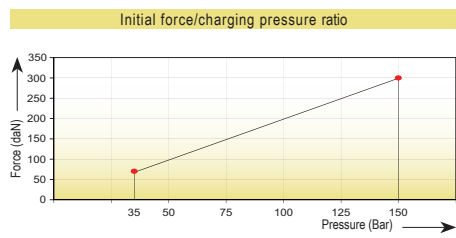
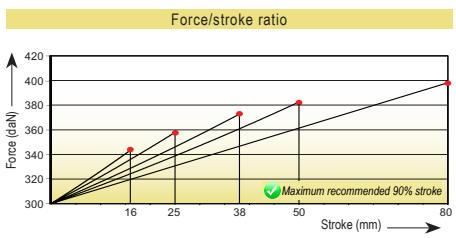

### Assembly possibilities



Follow guidelines  
Page 287

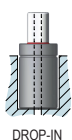

DROP-IN

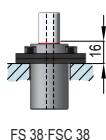

FS 38-FSC 38